

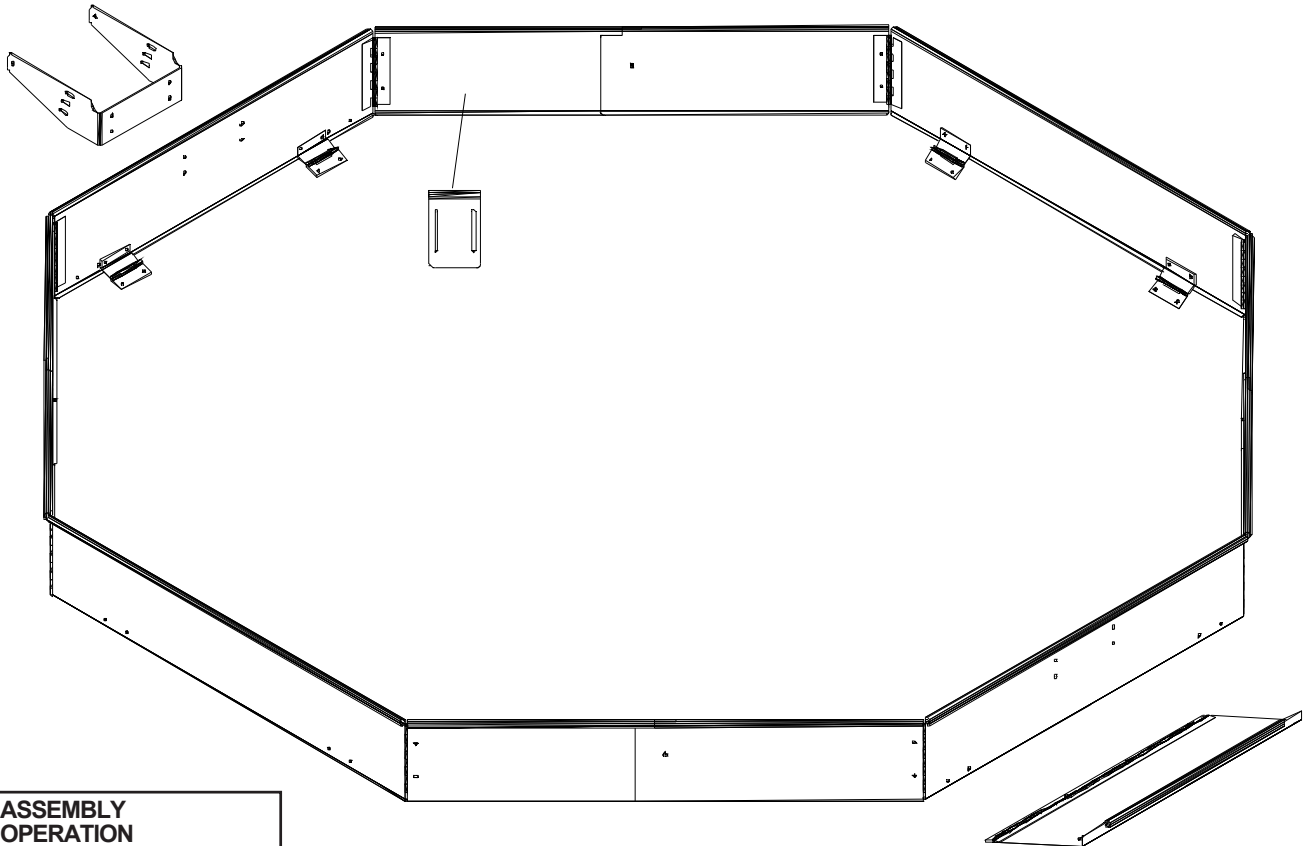

Combine Grain Tank Extension Tip-Up Kit CASE IH 2588 OPERATORS / ASSEMBLY MANUAL

**PLACE IN COMBINE CAB AFTER ASSEMBLY
FOR FUTURE REFERENCE.**



**ASSEMBLY
OPERATION
REPLACEMENT PARTS**

INTRODUCTION

Thank you for purchasing a Maurer grain tank extension Tip-Up kit. Proper care and use will result in many years of service.



WARNING: TO AVOID PERSONAL INJURY OR DEATH, OBSERVE THE FOLLOWING INSTRUCTIONS:

Ensure that anyone present is clear before applying power to any machinery used in conjunction with a Maurer grain tank extension.

Never allow anyone in or near the grain tank of a combine during loading or unloading of grain. The accumulation of grain is dangerous and can cause entrapment, resulting in serious injury or death by suffocation.

Do not exceed advertised maximum capacity of a Maurer grain tank extension.

GENERAL INFORMATION

1. Read assembly instructions carefully. Study assembly procedures and all illustrations before you begin assembly. Note which parts are used in each step. This unit must be assembled in proper sequence or complications will result.
2. When placing a parts order, refer to this manual for proper part numbers and place order by **PART NO.** and **DESCRIPTION.**
3. Whenever terms "**LEFT**" and "**RIGHT**" are used in this manual it means from a position behind combine and facing forward.

Table of Contents

General information	2
Safety, Signal Words	3
Product Safety Guidelines	4
Product Disclaimer	4
Safety Sign Locations	5
Safety Sign Care	5
Parts Breakdown	6-7
Assembly Instructions	7-8
Tank Full Sensor	8
GPS Bracket	8

SAFETY

TAKE NOTE! THIS SAFETY ALERT SYMBOL FOUND THROUGHOUT THIS MANUAL IS USED TO CALL YOUR ATTENTION TO INSTRUCTIONS INVOLVING YOUR PERSONAL SAFETY AND SAFETY OF OTHERS. FAILURE TO FOLLOW THESE INSTRUCTIONS CAN RESULT IN INJURY OR DEATH!



**THIS SYMBOL MEANS
ATTENTION
BECOME ALERT
YOUR SAFETY IS INVOLVED!**

SIGNAL WORDS

Note use of following signal words **DANGER**, **WARNING**, and **CAUTION** with safety messages. The appropriate signal word for each has been selected using the following guidelines:

DANGER: Indicates an imminently hazardous situation that, if not avoided, will result in death or serious injury. This signal word is to be limited to most extreme situations typically for machine components which, for functional purposes, cannot be guarded.

WARNING: Indicates a potentially hazardous situation that, if not avoided, could result in death or serious injury, and includes hazards that are exposed when guards are removed. It may also be used to alert against unsafe practices.

CAUTION: Indicates a potentially hazardous situation that, if not avoided, may result in minor or moderate injury. It may also be used to alert against unsafe practices.

If you have questions not answered in this manual, require additional copies, or if your manual is damaged, please contact your dealer or Maurer Manufacturing, P.O. Box 160, 1300 38th Ave. West, Spencer, Iowa 51301, Ph: (712) 262-2992 Fax: (712) 262-1022 www.maurermfg.com



PRODUCT SAFETY GUIDELINES

Every year many accidents occur which could have been avoided by a few seconds of thought and a more careful approach to handling equipment. You, the operator, can avoid many accidents by observing the following precautions in this section. To avoid personal injury, study the following precautions and insist those working with you, or you yourself, follow them.

Replace any caution, warning, danger or instruction safety decal that is not readable or is missing. Location of such decals is indicated in this booklet.

Review safety instructions with all users annually.

Operator should be a responsible adult. **DO NOT ALLOW PERSONS TO OPERATE OR ASSEMBLE THIS UNIT UNTIL THEY HAVE DEVELOPED A THOROUGH UNDERSTANDING OF SAFETY PRECAUTIONS AND HOW IT WORKS.**

Do not paint over, remove, or deface any safety signs or warning decals on your equipment. Observe all safety signs and practice instructions on them.

Never exceed limits of a piece of machinery. If it's ability to do a job, or to do so safely is in question **DON'T TRY IT.**

Fold and secure (if needed) the grain tank extension panels when transporting the combine to avoid contact with low power lines and other obstructions.

Ensure that any additional bracing and safety equipment have been installed according to this manual. (Some models do not require additional bracing or safety equipment)

Never exceed the maximum advertised capacity of the grain tank extension. By doing so you risk damage to the grain tank extension and combine.

PRODUCT DISCLAIMER

Increasing the grain tank capacity of any combine by use of this product is at the discretion of the owner. Increasing the grain holding capacity of any combine may affect the structural aspects of the combine as well as drive line components and tires. Although Maurer Mfg. has included additional support bracing on selected models, it does not assume liabilities, or make any warranties pertaining to the structural stability or performance of any combine. See the combine owners/operators manual for additional combine specifications and safety information not listed in this manual.



SAFETY SIGN LOCATIONS

Types of safety sign and locations on equipment are shown in illustration below. Good safety requires that you familiarize yourself with various safety signs, type of warning, and area or particular function related to that area, that requires your SAFETY AWARENESS.

FRONT

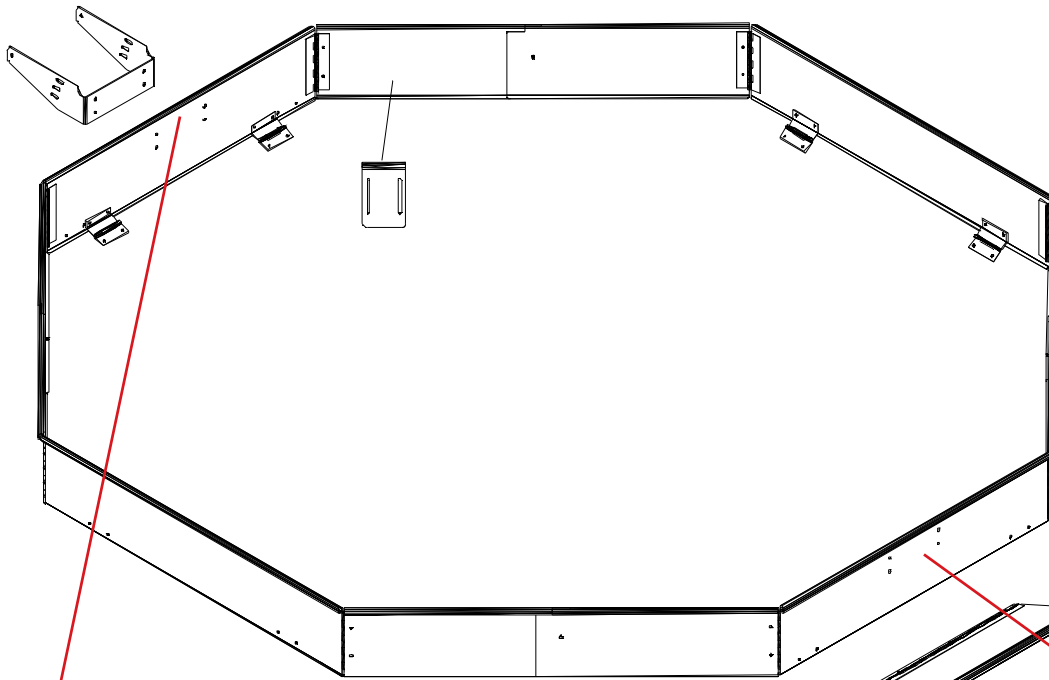

REAR



SAFETY SIGN CARE

- Keep safety signs clean and legible at all times.
- Replace safety signs that are missing or have become illegible.
- Replacement parts that displayed a safety sign should also display current sign.
- Safety signs are available from the Spencer plant.

Tip-Up Kit Parts Breakdown

2588 Tip-Up Kit for CASE IH 2588 Factory Bin Extension

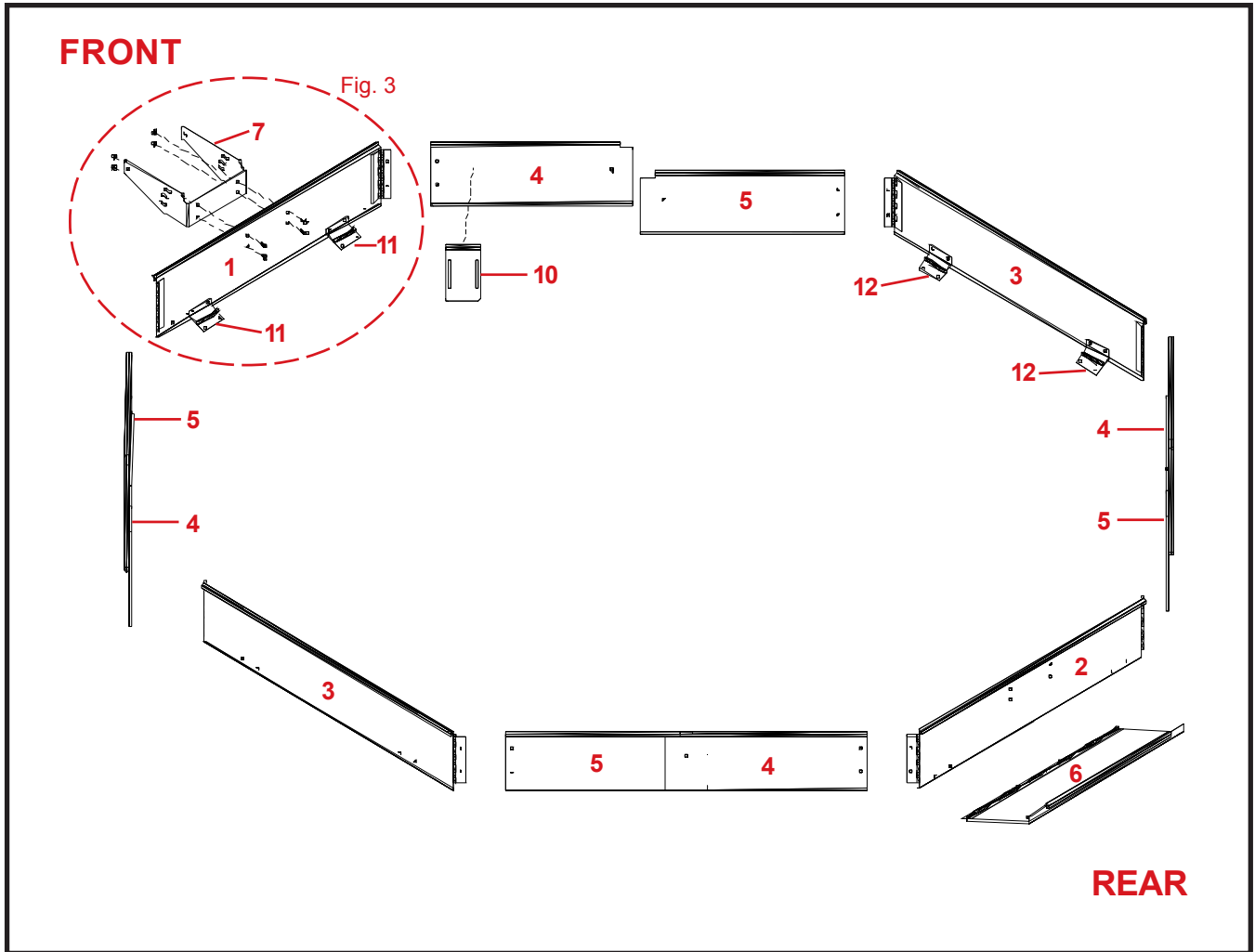

Figure 1

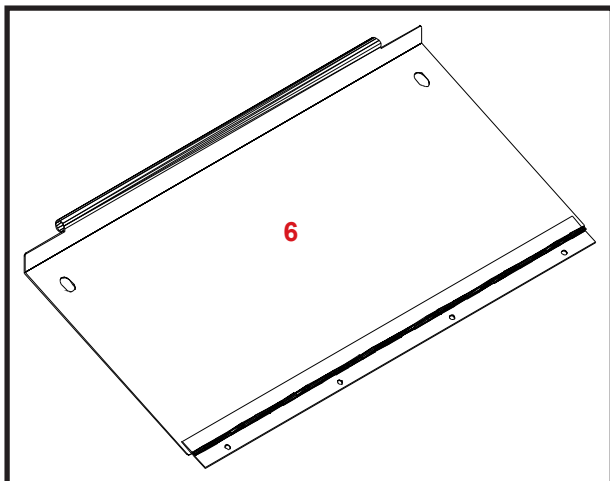

Figure 2

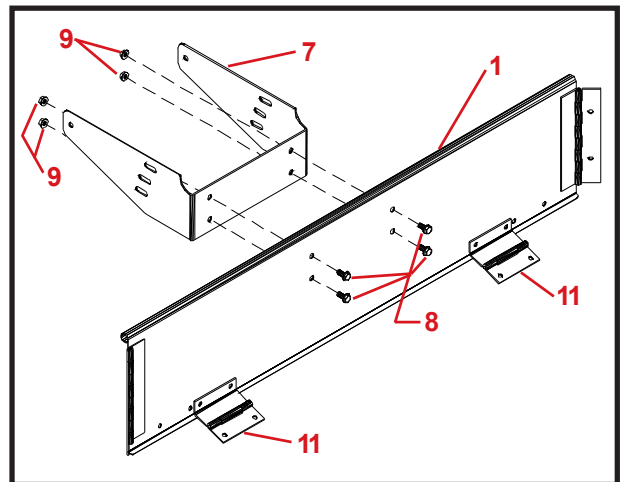

Figure 3

PARTS LIST

Please order replacement parts by **PART NO.** and **DESCRIPTION.**

REF. NO.	PART NO.	QTY.	DESCRIPTION
1.	R50003024Q1	1	Front Tip-Up Panel Assy. CIH-2588
2.	R50003025Q1	1	Rear Tip-Up Panel Assy. CIH-2588
3.	R50510603Q1	2	Side Tip-Up Panel Assy. CIH-2588
4.	R50530603Q1	4	Left Corner Tip-Up Panel Assy. CIH-2588
5.	R30287201Q1	4	Right Corner Tip-Up Panel CIH-2588
6.	R50003026Q1	1	Extension Access Panel CIH-2588
7.	R30007153Q1	1	GPS Bracket CIH-2588
8.	1AFC37FAA05	10	3/8" x 1" Serrated Flange Bolt
9.	1AFC08F0000	10	3/8" Flange Nut
10.	R30SENSTU-IHQ1	1	IH Sensor Bracket For Tip-Up
11.	R30040003-B	4	Tip-Up Hinge - Black - Front & Rear
12.	R30040003-S	4	Tip-Up Hinge - Silver - Sides
*13.	1AF013A2170	4	0.80 Hair Pin, Number 217
*14.	1AFC08D0000	48	1/4"-20 Serrated Flange Nut
*15.	1AFC12D00H0	16	1/4"-20 x 1/2" Hex Bolt
*16.	1AFC37D00H0	32	1/4"-20 x 1/2" Serrated Flange Bolt

* Indicates items not shown in illustrations

ASSEMBLY INSTRUCTIONS

STEP 1:

In the hardware kit locate the (4) black and (4) silver hinges. The black hinges assemble to the front and rear panels. (The front and rear panels are 44-1/4" long). The silver hinges assemble to the side panels. (The side panels are 49-3/16" long). Mount the bent leaf of the hinge to the Tip-Up panel. Using the 1/4" x 1/2" hex head bolts and the 1/4" serrated flange nuts, attach the hinges to the Tip-Up panels. (Hinges and nuts fasten to the **INSIDE** of panels.)

STEP 2:

Remove the rear access panel that is attached to the back panel of the CaseIH factory bin extension. Replace the access panel with Maurer panel provided, using the existing CIH fasteners. (See Figure 2.)

STEP 3:

Center the front Tip-Up panel (44-1/4" long) to the inside of the front CIH factory bin extension panel. Clamp each end of the panels together with a vise-grip or c-clamp. Use the holes in the flat leaf of the black hinge as a template, and drill four 5/16" holes thru the front bin extension panel. Fasten the hinges to the bin extension panel with (2) 1/4" x 1/2" serrated flange bolts and (2) 1/4" serrated flange nuts, per hinge. (See Figure 4.)

NOTE: Install both the Black and Silver hinges on the inside of the Tip-Up panels.

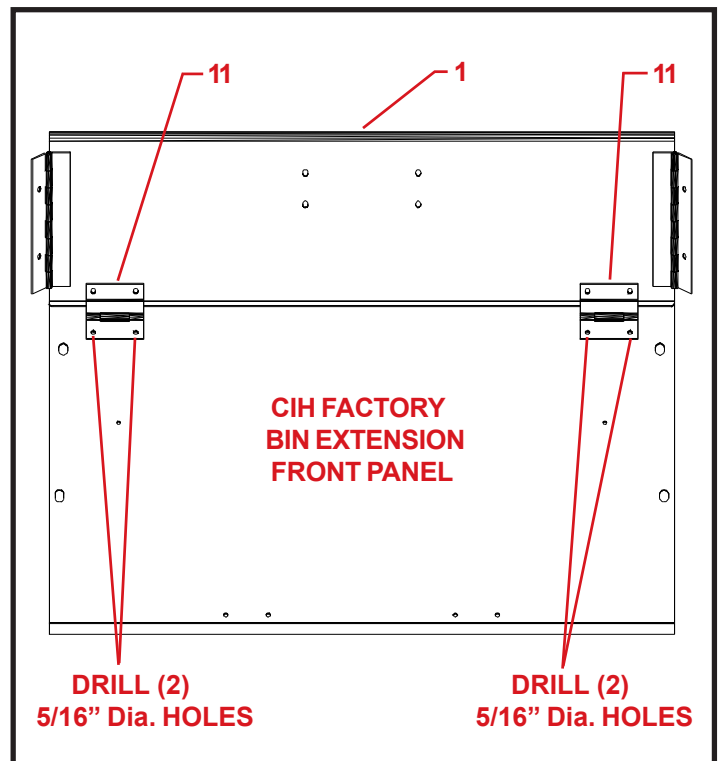

Figure 4



ATTENTION: During assembly ensure the following safety decals are located correctly. See illustration on page 5.



Located on outside of rear panel.



Located on inside of front panel.

STEP 4:

Repeat the instruction used in STEP 3 to install the rear Tip-Up panel.

STEP 5:

Center the side Tip-Up panels (49-3/16" long) to the inside of the side CIH factory bin extension panel. Clamp each end of the panels together with a vise-grip or c-clamp. Use the holes in the flat leaf of the silver hinge as a template, and drill four 5/16" holes through the bin extension's side panel. Fasten the hinges to the bin extension panel with (2) 1/4" x 1/2" serrated flange bolts and (2) 1/4" serrated flange nuts, per hinge.

STEP 6:

Once the front, rear, and side panels have been secured to the extension, fold the panels outward. Fasten a corner panel with clevis pin, to to the right hand side of the front Tip-Up panel using (2) 1/4" x 1/2" serrated flange bolts and 1/4" flange nuts. Fasten the the corner panel with the single hole to the left hand hinge, of the right side Tip-Up panel using (2) 1/4"x1/2" serrated flange bolts and 1/4" flange nuts. Insert the clevis pin in the single hole and secure with hair pin. Repeat with the remaining corner panels. (See Figure 5.)

TANK FULL BIN SENSOR

A sensor bracket has been provided, and will mount on the left side of the front right corner. Slide the sensor bracket over top of the curl, and position sensor vertically as necessary. (See Figure 6.)

GPS BRACKET

Remove the partial cut slugs from the front panel and fasten the provided GPS bracket to the outside of the panel using four 3/8" x 1" serrated flange bolts and four serrated flange nuts. (See Figure 7.)

NOTE: Corner panels are 28-5/16" long.

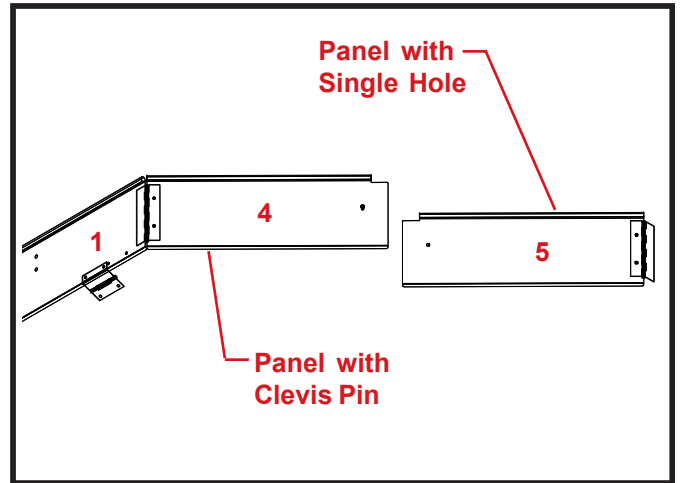

Figure 5

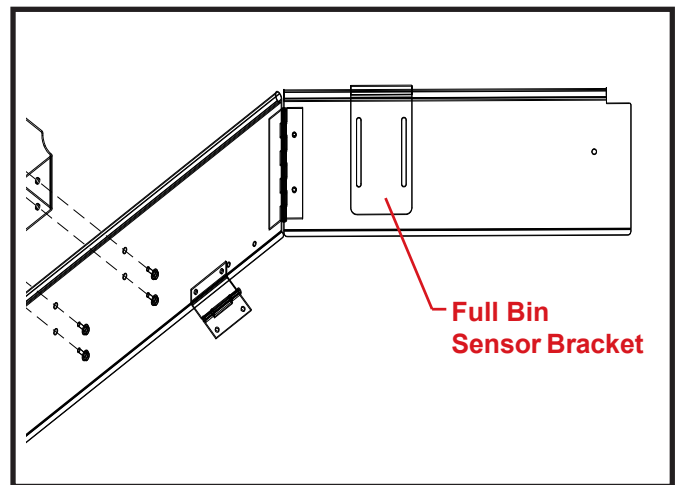

Figure 6

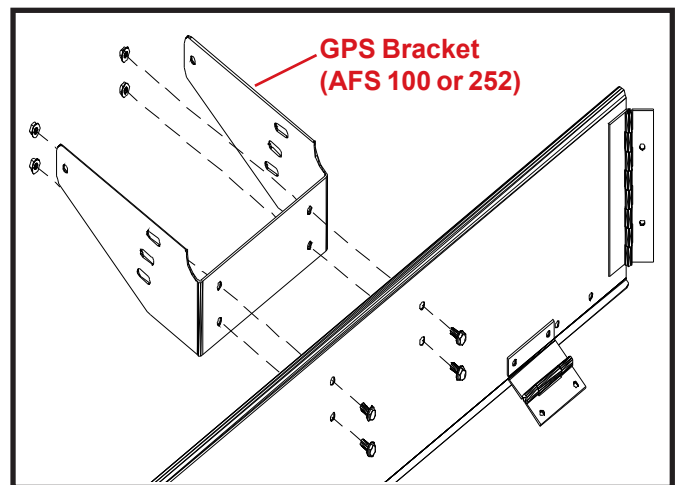

Figure 7